

Log in to Portal



# loyola.wired

An Insider's Guide to Loyola



Paula White  
Chat with 2 people  
No thanks. The one I did a

SEARCH  
Advanced Search | Search Tips

- HOME
- EMPLOYEE RESOURCES
- CLINICAL RESOURCES
- DEPARTMENTS
- POLICIES
- FORMS/PUBLICATIONS

Online Resources: [e-learning](#) | [Emergency Management](#) | [EPIC/EMR](#) | [Faculty Requisition](#) | [Find a Doctor](#) | [Help Desk](#) | [Insights](#) | [IDXRad](#) | [Kronos](#) | [Library](#) | [LUMEN](#) | [NDAS](#) | [On-call](#) | [Patient Safety Event Reporting](#) | [Employee Safety](#) | [Culture of Safety](#) | [Trinity Health Intranet \(Nexus\)](#) | [Teletracking](#) | [Nursing WFM](#) | [Gottlieb intranet](#) | [Trinity Outlook](#) | [Project & Space Request Form](#) | [Safety Data Sheets \(SDS\)](#)

### PHONE DIRECTORY

SEARCH

[Advanced Phone Search](#)

[Your Pager Groups](#)

[Emergency Alert System](#)

### INFORMATION PORTAL

Please enter your  
Loyola ID and  
password.

Logon ID

Password

LOGIN

### SPIRIT BLOG

- [Loyola Mourns the Passing of Linda Tintera](#)
- [Daily Ignatian Reflection with Ginny McCarthy and John Hardt: July 12, 2016](#)
- [Visiting Speaker and Traveling Art Work at the Cancer Center on Thursday, July 14](#)
- [Loyola Photo Booth Visits Start This Week](#)
- [Loyola Chapel Open to All Colleagues During All Hours](#)

### Spirit Archive:

[State of the System \(32\)](#) | [In the News \(10\)](#) | [Loyola Spirit \(230\)](#) | [General Announcements \(27\)](#) | [Obituaries \(51\)](#) | [See all Spirit entries](#)

### CALENDAR OF EVENTS

[Submit an Event](#) | [View All](#) | [Print this Weeks Events](#)

#### Today's Events

- Jul.13 [Grand Rounds](#)
- Jul.13 [Loyola Ostomy Support Group](#)
- Jul.13 [Cancer Immunology Program and Microbiology & Immunology](#)

#### Upcoming Events

- Jul.14 [Interfaith Bible Study](#)
- Jul.15 [Hematology/Oncology Grand Rounds](#)
- Jul.15 [Neurology Grand Rounds](#)
- Jul.21 [Interfaith Bible Study](#)
- Jul.22 [Oncology Research Institute Special Lecture](#)
- Jul.26 [Pediatric Grand Rounds](#)
- Jul.27 [Step Up Support Group for Amputees](#)
- Jul.28 [Interfaith Bible Study](#)
- Jul.29 [Neurology Grand Rounds](#)
- Jul.31 [Noon Mass of the Solemnity of St. Ignatius Loyola](#)

Report a Patient Safety Event

LEARN MORE

## BODY + SOUL

WE WANT TO HEAR YOUR STORIES

myLoyola.  
Your health. ONLINE

TALK TO YOUR DOCTOR

THE Magis Standard

Click Here to View the Video

You will see a list of applications.  
You may also have a drop down  
menu.

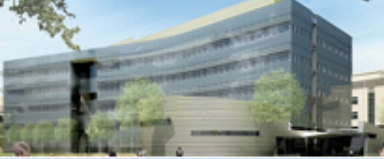

# loyola.wired

An Insider's Guide to Loyola

 **SEARCH**  
[Advanced Search](#) | [Search Tips](#)

- HOME
- EMPLOYEE RESOURCES
- CLINICAL RESOURCES
- DEPARTMENTS
- POLICIES
- FORMS/PUBLICATIONS

**Online Resources:** [e-learning](#) | [Emergency Management](#) | [EPIC/EMR](#) | [Faculty Requisition](#) | [Find a Doctor](#) | [Help Desk](#) | [Insights](#) | [IDXRad](#) | [Kronos](#) | [Library](#) | [LUMEN](#) | [NDAS](#) | [On-call](#) | [Patient Safety Event Reporting](#) | [Employee Safety](#) | [Culture of Safety](#) | [Trinity Health Intranet \(Nexus\)](#) | [Teletracking](#) | [Nursing WFM](#) | [Gottlieb intranet](#) | [Trinity Outlook](#) | [Project & Space Request Form](#) | [Safety Data Sheets \(SDS\)](#)

**PHONE DIRECTORY**

 **SEARCH**

**INFORMATION PORTAL**

Welcome **Scott Graziano**

[Portal Home](#) [Logout](#)

**MyFAVORITES** + -

- [ACOG](#)
- [APGO](#)
- [Ob/Gyn Home Page](#)

[Customize loyola.wired](#)

**LAWSON**  
Log into LAWSON

[Clerkship](#) [Dean](#) [Information](#) [Professional](#) [Research](#)

- [Clerkship Administration](#)
- [Exam Administration](#)
- [LUMEN Online Exams](#)
- [SSOM Calendar Report](#)
- [Student Grading System](#)
- [Student Log Reports](#)
- [Student Portfolio](#)



Find the application:  
Clerkship Administration



Online Resources: [e-learning](#) | [Emergency Management](#) | [EPIC/EMR](#) | [Faculty Requisition](#) | [Find a Doctor](#) | [Help Desk](#) | [Insights](#) | [IDXRad](#) | [Kronos](#) | [Library](#) | [LUMEN](#) | [NDAS](#) | [On-call](#) | [Patient Safety Event Reporting](#) | [Employee Safety](#) | [Culture of Safety](#) | [Trinity Health Intranet \(Nexus\)](#) | [Teletracking](#) | [Nursing WFM](#) | [Gottlieb intranet](#) | [Trinity Outlook](#) | [Project & Space Request Form](#) | [Safety Data Sheets \(SDS\)](#)

### PHONE DIRECTORY

SEARCH  
Advanced Phone Search  
[Your Pager Groups](#)  
[Your Pages](#)  
[Emergency Alert System](#)

### INFORMATION PORTAL

Welcome **Scott Graziano**  
[Portal Home](#) [Logout](#)

### MyFAVORITES

[ACOG](#)  
[APGO](#)  
[Ob/Gyn Home Page](#)

Customize [loyola.wired](#)



[Clerkship](#) [Dean](#) [Information](#) [Professional](#) [Research](#)

- ✓ Select Application to Run
  - Academic Center for Excellence Meeting Request
  - Administrator Information System
  - Ambulatory Services
  - Animal Exposure Assessment
  - Annual Disclosure Statement
  - Cadence Request Forms
  - Census Reports
  - Clerkship Administration**
  - Clinical Research Database
  - Clinical Research Marketing
  - Committee Tracker
  - Corporate Compliance Survey
  - Corrective Action
  - Coumadin Patient System
  - Course Administration
  - CPT Lookup
  - CRDB: The Clinical Research Database
  - Customize Portal
  - Digital Archive Tracking Application (DATA)
  - Educational Dashboard
  - Elective Administration
  - Emergency Broadcast System
  - Employee Occurrence Report
  - Exam Administration



On the left, click on:  
Clinical Performance

Year: 2017 Update

--- MENU ---

- Clerkship Reports
- Instructions
- Clerkship Reports
- Elective Evaluations
- Administration
- Clerkship Eval Administration
- Clerkship Competency
- Clinical Performance



## Welcome to the Clerkship Evaluation Reports

If you have any technical questions or problems, please contact [Amy Hoyt](#) in the Office of Web Development either via email ([ahoyt@luc.edu](mailto:ahoyt@luc.edu)) or phone at ext. 6-5207.

If you have any questions about the information contained in the reports, please contact Sandra Cavalieri either via email [scavali@luc.edu](mailto:scavali@luc.edu) or at ext. 6-8192.

Please click on any of the reports in the left hand column to continue.



Click on Evaluation Form

Year: 2017 Update

--- MENU ---

- Clerkship Reports
- Instructions
- Clerkship Reports
- Elective Evaluations
- Administration
- Clerkship Eval Administration
- Clerkship Competency
- Clinical Performance
- Evaluation Form

## Welcome to the Clerkship Evaluation Reports

If you have any technical questions or problems, please contact [Amy Hoyt](#) in the Office of Web Development either via email ([ahoyt@luc.edu](mailto:ahoyt@luc.edu)) or phone at ext. 6-5207.

If you have any questions about the information contained in the reports, please contact Sandra Cavalieri either via email [scavali@luc.edu](mailto:scavali@luc.edu) or at ext. 6-8192.

Please click on any of the reports in the left hand column to continue.



Select the clerkship from the  
drop down menu

Year: 2017 Update

--- MENU ---

- Clerkship Reports
- Instructions
- Clerkship Reports
- Elective Evaluations
- Administration
- Clerkship Eval Administration
- Clerkship Competency
- Clinical Performance
- Evaluation Form

### Clinical Performance Evaluation Form

Course/Clerkship: FAMILY MEDICINE CLERKSHIP (CLK-123)

Please select a clerkship and period and click the 'Get Students' button to begin

Year: 2017 Update

- MENU ---
- Clerkship Reports
- Instructions
- Clerkship Reports
- Elective Evaluations
- Administration
- Clerkship Eval Administration
- Clerkship Competency
- Clinical Performance
- Evaluation Form

### Clinical Performance Evaluation Form

Course/Clerkship

Please select a clerkship to begin

- ✓ FAMILY MEDICINE CLERKSHIP (CLK-123)
- MEDICINE CLERKSHIP (CLK-116)
- NEUROLOGY CLERKSHIP (CLK-122)
- OB-GYN CLERKSHIP (CLK-120)
- PEDIATRICS CLERKSHIP (CLK-118)
- PSYCHIATRY CLERKSHIP (CLK-119)
- SUBINTERN-ICU (CLK-125)
- SUBINTERN-WARDS (CLK-124)
- SURGERY CLERKSHIP (CLK-117)

Select the clerkship rotation:  
Currently Jul 6

Year: 2017 Update

- MENU ---
- Clerkship Reports
- Instructions
- Clerkship Reports
- Elective Evaluations
- Administration
- Clerkship Eval Administration
- Clerkship Competency
- Clinical Performance
- Evaluation Form

### Clinical Performance Evaluation Form

**Course/Clerkship:** OB-GYN CLERKSHIP (CLK-120) Apr6 Get Students

Please select a clerkship and period and click the 'Get Students' button to begin

Year: 2017 Update

--- MENU ---

- Clerkship Reports
- Instructions
- Clerkship Reports
- Elective Evaluations
- Administration
- Clerkship Eval Administration
- Clerkship Competency
- Clinical Performance
- Evaluation Form

### Clinical Performance Evaluation Form

Course/Clerkship: OB-GYN CLERKSHIP (CLK-120)  Apr6  Aug6  Feb6  Jan6  Jul6  May6  Nov6  Oct6

Please select a clerkship and period and click the 'Get Students' button to begin

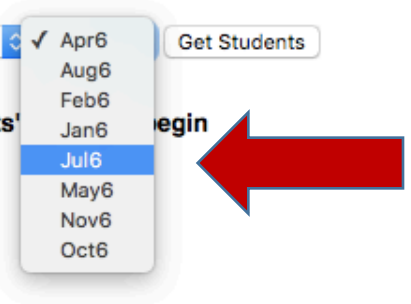



Click on Get Students

Year: 2017 Update

--- MENU ---

- Clerkship Reports
- Instructions
- Clerkship Reports
- Elective Evaluations
- Administration
- Clerkship Eval Administration
- Clerkship Competency
- Clinical Performance
- Evaluation Form**

### Clinical Performance Evaluation Form

Course/Clerkship: OB-GYN CLERKSHIP (CLK-120)  Apr6  Aug6  Feb6  Jan6  Jul6  May6  Nov6  Oct6

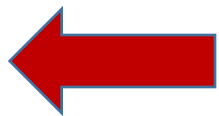

Please select a clerkship and period and click the 'Get Students' button to begin

Select student from drop down  
menu

Year: 2017 Update

- MENU ---
- Clerkship Reports
- Instructions
- Clerkship Reports
- Elective Evaluations
- Administration
- Clerkship Eval Administration
- Clerkship Competency
- Clinical Performance
  - Evaluation Form

### Clinical Performance Evaluation Form

#### CLK-120 Jul6 Students

- Students
- ✓ Auguston, Trent Jordan
  - Bielecki, Emil
  - Chang, Victor
  - Dowd, Jonathan Robert
  - Jones, Kamaal Ali
  - Korpics, Jessica Ann
  - Kosteva, Adam Richard-Bernard
  - McConkey, Kevin Thomas
  - McGurn, Andrew Wallace
  - Mejias-Beck, Johana Carolina
  - Palmere, Laura Nicolle Frazier
  - Patel, Ushma Jaymin
  - Pytel, Jamie Lynn
  - Romano, Joseph William
  - Tripp, Michael Patrick
  - Truong, Alexander Hoang
  - Weaver, John Joseph
  - Zeglin, Alissa Faith

Select site from drop down menu

Year: 2017 Update

--- MENU ---

- Clerkship Reports
- Instructions
- Clerkship Reports
- Elective Evaluations
- Administration
- Clerkship Eval Administration
- Clerkship Competency
- Clinical Performance
- Evaluation Form**

### Clinical Performance Evaluation Form

#### CLK-120 Jul6 Students

S [dropdown]

S [dropdown] ✓ Gottlieb [dropdown] Select Site and go to Evaluation >>

**Loyola**

Mercy Hospital



**Jones, Kamaal A**

Select Go To Evaluation

Year: 2017 Update

--- MENU ---

- Clerkship Reports
- Instructions
- Clerkship Reports
- Elective Evaluations
- Administration
- Clerkship Eval Administration
- Clerkship Competency
- Clinical Performance
- Evaluation Form**

### Clinical Performance Evaluation Form

**CLK-120 Jul6 Students**

Students: Jones, Kamaal Ali

Sites:  Gottlieb  Loyola  Mercy Hospital

Select Site and go to Evaluation >>

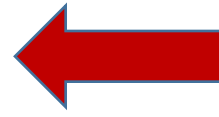

Jones, Kamaal A



Fill out the evaluation

Year: 2017 Update

--- MENU ---

- Clerkship Reports
- Instructions
- Clerkship Reports
- Elective Evaluations
- Administration
- Clerkship Eval Administration
- Clerkship Competency
- Clinical Performance
- Evaluation Form

### Clinical Performance Evaluation Form

**CLK-120 Jul6 Students**

Students: Jones, Kamaal Ali

Sites: Loyola Select Site and go to Evaluation >>



No Capacity to Act	Safe with Direct Observation	Safe with Direct Observation	Safe with Indirect Observation	Safe in Teaching Capacity	NA
<b>Gather essential and accurate information about patients and their condition through history, physical examination, and the use of laboratory data, imaging, and other tests</b>					
Information unreliable, omissions, disorganized approach	Limited prioritizing of findings, incorrectly performing physical exam maneuvers	Information with some omissions, connecting information to existing factual knowledge, demonstrates patient centered information gathering	Prioritizes information, with most pertinent positives and negatives, performs basic physical exam maneuvers correctly	Gathers focused information in urgent, emergent or consult setting, identifies alternative sources of information	
<input type="radio"/>	<input type="radio"/>	<input type="radio"/>	<input type="radio"/>	<input type="radio"/>	<input checked="" type="radio"/>
<b>Interpret laboratory data, imaging studies, and other tests required for the area of practice</b>					
Unable to interpret data	Provides list of standard labs/imaging, unable to prioritize/provide rationale for ordering	Provides initial plan for lab/imaging, targeted to working diagnosis, occasionally misinterprets data, may fail to recognize urgency of abnormalities	Consistently interprets data accurately, provides rationale for each test	Identifies urgent values without assistance, provides clear rationale for recommendations	
<input type="radio"/>	<input type="radio"/>	<input type="radio"/>	<input type="radio"/>	<input type="radio"/>	<input checked="" type="radio"/>
<b>Identify strengths, deficiencies, and limits in one's knowledge and expertise, Incorporate feedback into daily practice</b>					
No	Defensiveness with feedback, limited	Solicits feedback, can recognize self-limitations, organizes	Routinely solicits feedback, actively reflects	Routinely reflects on substantial practice	
<input type="radio"/>	<input type="radio"/>	<input type="radio"/>	<input type="radio"/>	<input type="radio"/>	<input checked="" type="radio"/>

Add comments

Click on submit to finalize

Year: 2017 Update

--- MENU ---

- Clerkship Reports
- Instructions
- Clerkship Reports
- Elective Evaluations
- Administration
- Clerkship Eval Administration
- Clerkship Competency
- Clinical Performance
- Evaluation Form

### Clinical Performance Evaluation Form

#### CLK-120 Jul6 Students

Students: Jones, Kamaal Ali

Sites: Loyola Select Site and go to Evaluation >>



Jones, Kamaal A

**(see also interprofessional collaboration competency)**

<p>Fails to communicate with other team members (does not answer page, etc)</p>	<p>Communication rigid, little insight into situation, avoids difficult conversations</p>	<p>Active listener, engages team members (including supervisor), Discusses plans, keeps team up to date on activities</p>	<p>Can participate in unfamiliar situations, engages others, even with difficult conversations</p>	<p>Effective communicator with difficult/uncomfortable conversations</p>
<input type="radio"/>	<input type="radio"/>	<input type="radio"/>	<input type="radio"/>	<input checked="" type="radio"/>

**Demonstrate compassion, integrity, and respect for others**

<p>Disrespectful interactions, does not tell truth, generates conflicts</p>	<p>Needs to be reminded of proper conduct, difficulty modifying behavior, especially with stress/fatigue</p>	<p>Demonstrates professional conduct, tells truth, respectful interactions</p>	<p>Remains professional with stress and fatigue, does not need reminders to modify behavior</p>	<p>Professional conduct in all circumstances, understands own triggers for lapses</p>
<input type="radio"/>	<input type="radio"/>	<input type="radio"/>	<input type="radio"/>	<input checked="" type="radio"/>

**Comments**

Submit Evaluation

